

Installation Guide

2.8-inch Series Product

Version: 1.0

1. Device Installation

Please refer to the following recommendations for installation. The following illustration takes the device with camera as an example.

Installation Environment



INSTALL INDOORS
ONLY



AVOID INSTALLATION
NEAR
GLASS WINDOWS



AVOID DIRECT
SUNLIGHT
AND EXPOSURE



AVOID USE OF ANY
HEAT SOURCE
NEAR THE DEVICE

Install on the wall

- ① Attach the mounting template sticker to the wall, and drill holes according to the mounting paper.
- ② Fix the backplate on the wall with the wall mounting screws.
- ③ After passing the wires through the wiring hole and connecting them to the device, and then snap the device onto the backplate and push it down into place.
- ④ Fasten the device to the backplate with a security screw.

①

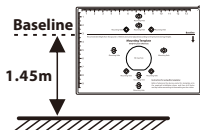

②

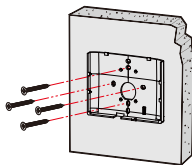

③

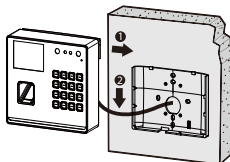

④

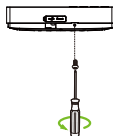

2. Power Connection

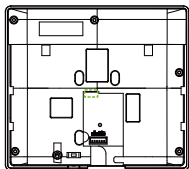

- Recommended AC adapter: **12V, 3A**
- To share power with other devices, use an AC adapter with higher current ratings.

3. Ethernet Connection

Connect the device and computer software via an Ethernet cable. As shown in the example below:

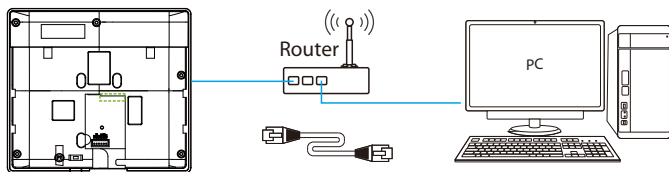

Enter **[COMM.] > [Ethernet]** to set the relevant parameters of network.

4. Door Sensor & Exit Button Connection

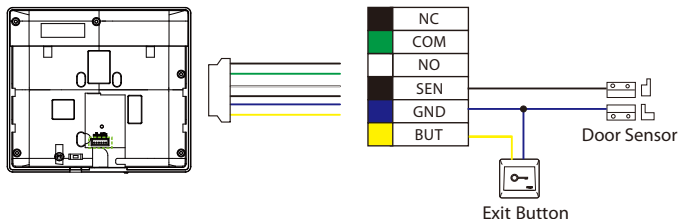

5. Lock Relay Connection

The system supports Normally Opened Lock and Normally Closed Lock. The NO LOCK (normally unlocks when power on) is connected with 'NO' and 'COM' terminals, and the NC LOCK (normally locks when power on) is connected with 'NC' and 'COM' terminals. Take NC Lock as an example below:

1) Device not sharing power with the lock

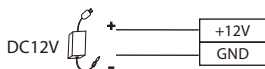

⚠ Do not reverse the polarity.

Normally Closed Lock

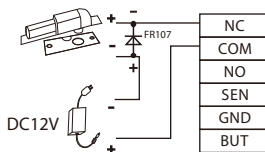

⚠ Maximum 30V 3A input.

2) Device sharing power with the lock

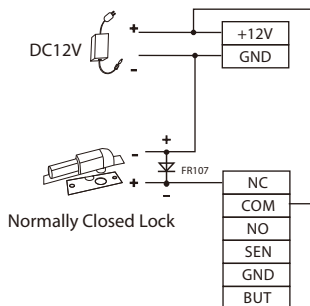

6. Download Center

Scan the QR Code to download the **User Manual, Installation Guide** and **Quick Start Guide**.



QR Code (Download Center)

